

Ingersoll's Addition to the Village of Grand Ledge

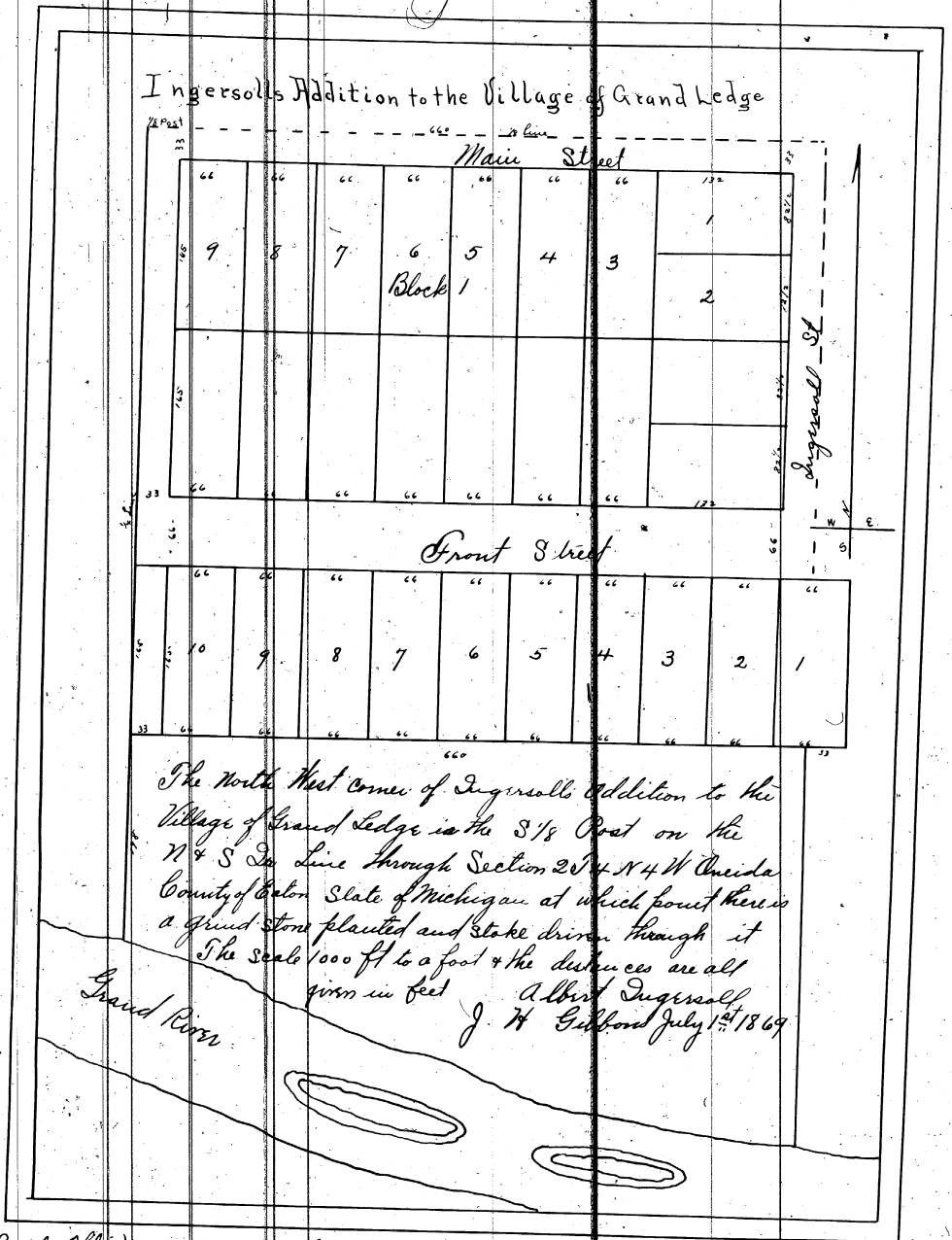

The North West corner of Ingersoll's Addition to the Village of Grand Ledge is the 3 1/8 Post on the N & S In Line through Section 25 & N 4 W Oneida County of Eaton State of Michigan at which point there is a ground stone planted and stake driven through it. The scale 1000 ft to a foot & the distances are all given in feet. Albert Ingersoll J. H. Gibbons July 1st 1869

Register Office, Eaton County } The annexed Plat of the Village of Ingersoll's Addition to the Village of Grand Ledge was recorded this 12th day of July 1869 at 9 o'clock A.M. B. N. Warren Register.

State of Michigan } On this Eight day of July A. D. 1869 County of Eaton } before me personally came Albert Ingersoll known to me to be the person who signed this Plat as proprietor & acknowledged the same to be his free act & deed. Also J. H. Gibbons who signed the same as Surveyor Albert Ingersoll J. H. Gibbons Surveyor

Samuel Chadwick Justice of the Peace.

I hereby certify that this Plat is a correct copy of the Plat now on Record in the Register of Deeds Office, being made under the supervision of the Auditor General by tracing the Plat on Record and affixing thereto a carefully compared copy of the Certificate. Dated the 24th day of April 1871 Alton B. Church Clerk and Gen. Ref.